

AP MORGAN



Fir Tree Close, Batchley, Redditch
Offers in excess of £185,000

Features:

- Chain-free
- Two-bedroom terraced house
- Well-fitted Kitchen/Diner
- Spacious Lounge/Dining Room with sliding doors to garden
- Two double bedrooms
- Bathroom
- Versatile garden space
- Driveway for parking vehicles

Description:

A well-presented, two-bedroom terraced house that offers ample room sizes, two double bedrooms, a generous lounge/dining room, and private positioning in Batchley, Redditch.

To the front of the property is a brief garden space laid to a slate stone-shingle.

The accommodation comprises: a welcoming porch, the well-fitted kitchen/diner that provides a sink, integrated gas hob/convection oven, breakfast bar, space/plumbing for freestanding appliances, the lounge/dining room features a gas fireplace, stairs rising to the first floor and access to the rear garden through a set of glazed sliding doors.

The first-floor landing establishes: Bedroom one, a double with an integrated wardrobe and bedroom two is a further, comfortable double. The bathroom of the house features a bath/shower, sink and WC.

To the rear of the property is a low-maintenance garden space laid to an initial slab-patio with a further central space laid to a stone shingle with a stone-slab path leading through, to a further paved area. This garden features fenced boundaries.

Situated in Batchley, this property is less than a mile from the Redditch town centre, this position offers access to an assortment of amenities including shopping, bars and restaurants, along with the local bus and railway stations. Additionally, the M5 and M42 motorways are accessible.



Details:

Porch

Kitchen/Diner 12' x 12' (3.66m x 3.66m) Both max

Lounge/Dining Room 15'5" x 12' (4.7m x 3.66m)

Landing

Bedroom one 8'8" x 12' (2.64m x 3.66m)

Bedroom two 11'10" x 8'2" (3.6m x 2.5m) Both max

Bathroom 8' x 4'5" (2.44m x 1.35m)



EPC Rating: C

Council Tax Band: C (tbc by solicitors).

Tenure: Freehold (tbc by solicitors).

For more information or to arrange a viewing, please call us on 01527 406 956.

How can we help you?

Need a mortgage?

We recommend Wisser Mortgage Advice. They will search the market for you to ensure you get the right lender and mortgage deal. They typically achieve mortgage offers much more quickly than if you were dealing with lenders directly. The initial appointment is free and without obligation. Call us on 01527 406 956, or visit their website for more information: www.wissermortgageadvice.co.uk

Property to sell?

If you need to sell a property in order to buy, you ideally need to be on the market at least (and preferably Sold STC) before viewing, otherwise you may lose out to other buyers when the right property comes along. In these circumstances we can get your property 'live' quickly. Just book a free valuation and we will visit your property and discuss your needs.

Need a solicitor?

A good solicitor can save you literally weeks of time in the buying/selling process, reducing the stress levels of all involved. We will instruct a reputable firm that is competitive on cost and very reliable. Just ask for a quote.

Need a removal company and storage?

A professional removal company takes the stress out of moving. Knowing that your belongings are safe and insured far outweighs any small savings by trying to do it yourself or using a man-and-a-van service. We work closely with and recommend Cube Removals as the leading local firm. For peace of mind and a reliable service call them on 0800 193 0000 or visit their website, cuberemovals.co.uk, to arrange a survey.

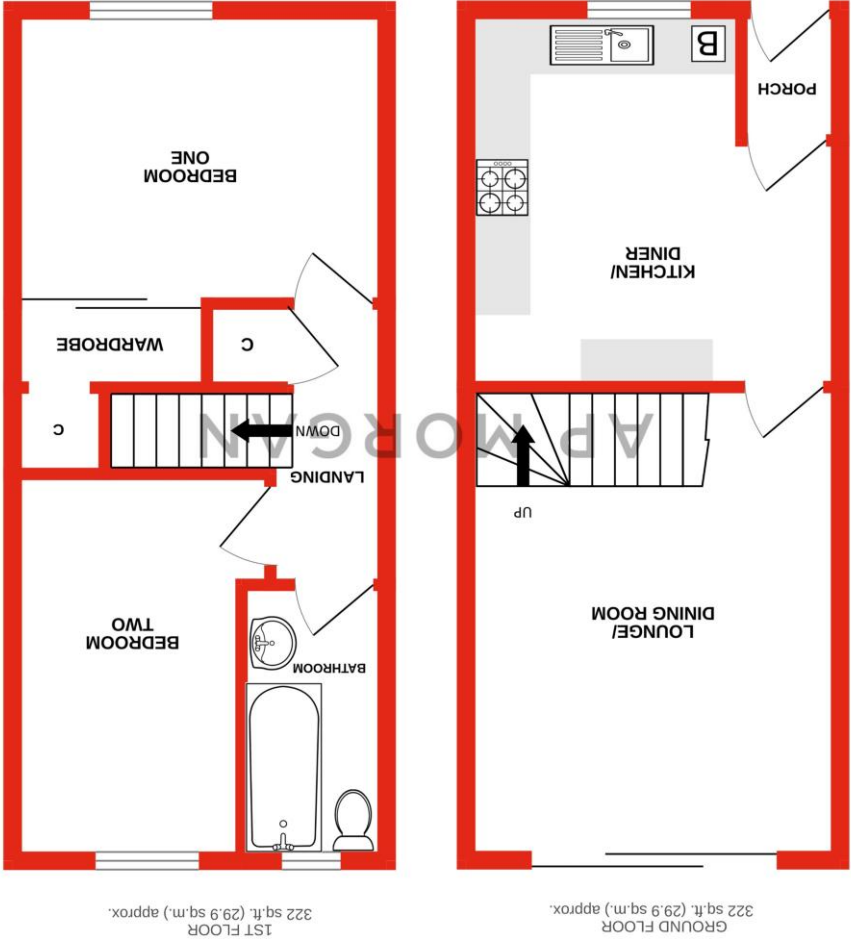

No statement in these details is to be relied upon as representation of fact, and purchasers should satisfy themselves by inspection or otherwise as to the accuracy of the statements contained within. These details do not constitute any part of any offer or contract. AP Morgan and their employees and agents do not have any authority to give any warranty or representation whatsoever in respect of this property. These details and all statements herein are provided without any responsibility on the part of AP Morgan or the vendors. Equipment: AP Morgan has not tested the equipment or central heating system mentioned in these particulars and the purchasers are advised to satisfy themselves as to the working order and condition. Measurements: Great care is taken when measuring, but measurements should not be relied upon for ordering carpets, equipment, etc. The Laws of Copyright protect this material. AP Morgan is the Owner of the copyright. This property sheet forms part of our database and is protected by the database right and copyright laws. No unauthorised copying or distribution without permission.